

EZ-240-NM (3190-1127)

EZ-240-TM (3190-1128)

CABLE TYPES: LMR-240, 240-DB, 240-FR, 240-PVC, 240-LLPL
(NOT RECOMMENDED FOR LMR-240-ULTRA-FLEX)

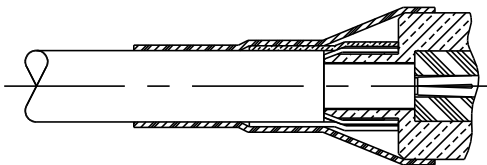
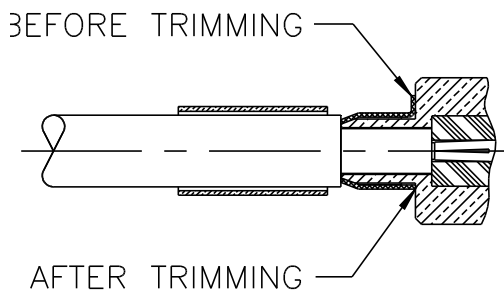
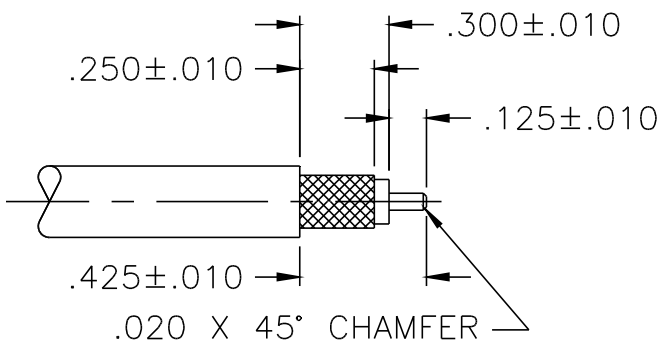

- Trim cable to dimensions shown using a razor knife.
 - Remove any residual plastic from the center conductor.
 - Deburr center conductor using a fine file or Times DBT-01 tool.
- Slide heat shrink tube and crimp ring over cable.
 - Insert cable into connector body until dielectric is fully seated and center conductor is inserted fully into connector center pin.
 - Trim excess braid flush to back of connector body. (optional)
- Slide crimp ring over braid and crimp as close as possible to connector body using a .255" hex die. Use Times HX-4 tool or equivalent.
 - Heat shrink weather seal over rear of connector body and down onto cable jacket using a hot air gun.