

3 1 9 0 - 6 2 1 1

TC-600-716M-RA-D  
3190-6211

7/16 Male (Plug) Right Angle Solder Pin  
Connector for LMR-600 Cable

Made in China

## Installation Instruction

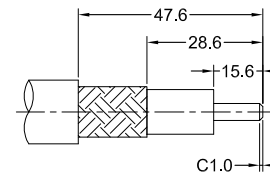

Dimensions in millimeters

1. A. Trim cable to dimensions shown. Be careful to avoid nicking the braid  
B. Remove any residual plastic from center conductor

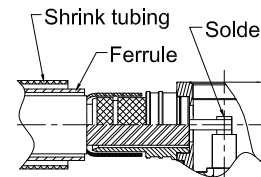

2. A. Slide the shrink tubing, ferrule over the cable as shown  
B. Insert cable into connector body until it stops, with all braid wires on the outside of connector body  
C. Solder conductor of cable to contact pin as shown  
Control the solder time

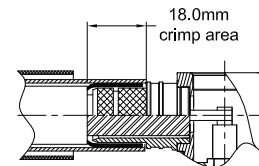

3. A. Slide the ferrule over braid and crimp as close to body as possible using .610" HEX crimp tooling  
Pay attention to the crimp area, do not crimp rear of crimp sleeve

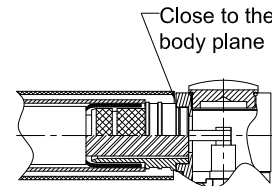

4. A. Install screw cap  
B. Heat shrink tube over rear of connector body and down on to cable jacket using hot air gun