

LTR	DESCRIPTION	DATE	BY
-	Released	9/30/96	JCL
A	Updated Outline Drawing & Finishes	6/18/03	JCL

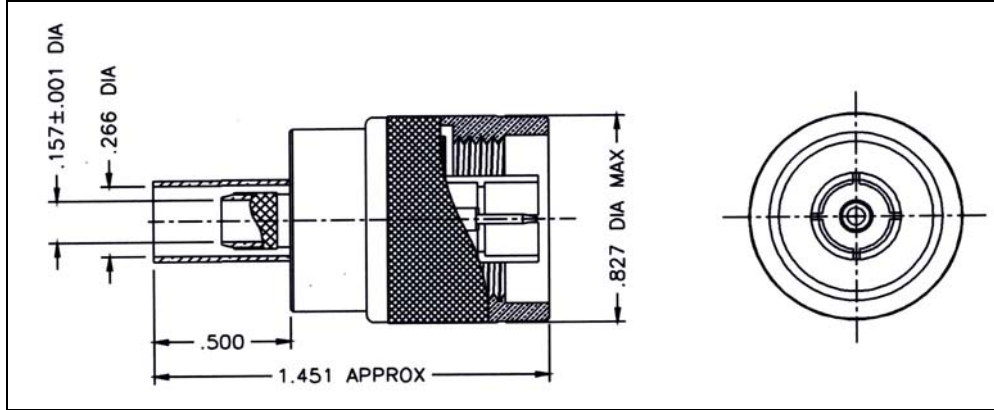

I. MATERIALS & FINISHES

- center contact: Gold Plated Brass
- outer contact: Nickel Plated Brass
- body: Nickel Plated Brass
- coupling nut: Nickel Plated Brass (knurled)
- crimp sleeve: Nickel Plated Copper
- dielectric: Teflon® PTFE
- gasket: Silicone Rubber
- shrink sleeve: Adhesive Lined Polyolefin
- attachment: braid crimp (.255" hex)

II. ELECTRICAL PROPERTIES

- impedance: 75 ohms
- working voltage: 500 vrms (max)
- vswr: 1.25:1 (max) up to 2 GHz
- insertion loss: 0.10 x √Fghz

Unless otherwise specified, dimensions are in inches. Tolerances are applicable when specified.

These drawings and specifications contain proprietary information which is the property of Times Microwave Systems.

Approvals		
Drawn	JCL	9/30/96



TIMES MICROWAVE SYSTEMS

Wallingford, CT 06492
 (203) 949-8400; (203) 949-8423.Fax
 www.timesmicrowave.com

TC-240-NM-75

Type N Male (Plug)
 for LMR-240-75 Cable

Size A	CAGE CODE 68999	Drawing No.: 3190-477
-----------	---------------------------	---------------------------------

Scale: NA	Rev. (A)	Sheet: 1 of 1
-----------	----------	---------------